

MCCB-250

MOLDED-CASE CIRCUIT BREAKER TESTER

USER'S MANUAL



Vanguard Instruments Company, Inc.

1520 S. Hellman Ave.

Ontario, California 91761, USA

TEL: (909) 923-9390
FAX: (909) 923-9391

September 2009
Revision 2

SAFETY SUMMARY

FOLLOW EXACT OPERATING PROCEDURES

Any deviation from the procedures described in this User's Manual may create one or more safety hazards, may damage the MCCB-250, or cause errors in the test results. Vanguard Instruments Company, Inc. assumes no liability for unsafe or improper use of the MCCB-250.

All safety precautions provided in this manual must be observed during all phases of testing including test preparation, test lead connection, actual testing, and test lead disconnection.

SAFETY WARNINGS AND CAUTIONS

Only trained operators shall use this device. **All circuits under test shall be off-line and fully isolated.**

DO NOT MODIFY TEST EQUIPMENT

To avoid the risk of introducing additional or unknown hazards, do not install substitute parts or perform any unauthorized modification to any MCCB-250 test unit. To ensure that all designed safety features are maintained, it is highly recommended that repairs be performed only by Vanguard Instruments Company factory personnel or by an authorized repair service provider. Unauthorized modifications can cause safety hazards and will void the manufacturer's warranty.

TABLE OF CONTENTS

CONVENTIONS USED IN THIS DOCUMENT	1
1.0 INTRODUCTION.....	2
1.1 General Description and Features	2
1.2 Furnished Accessories.....	2
1.3 MCCB-250 Technical Specifications.....	3
1.4 Controls and Indicators.....	4
2.0 FUNCTIONAL DESCRIPTION	6
2.1 MCCB-250 AC Current Source.....	6
2.2 MCCB-250 Current Output Control	7
2.3 Timer Stop Input and Control	8
2.4 MCCB-250 Timer	9
2.5 External Current Input	9
2.6 LCD Contrast Control	9
3.0 OPERATING PROCEDURES	10
3.1 Testing the Time Delay of a Protection Relay.....	10
3.2 Measuring Current Transformer Primary and Secondary Currents	12

LIST OF TABLES

Table 1. MCCB-250 Technical Specifications	3
Table 2. Functional Descriptions of MCCB-250 Controls and Indicators.....	5
Table 3. MCCB-250 Current Output.....	6
Table 4. MCCB-250 Overload Current Output.....	6

LIST OF FIGURES

Figure 1. MCCB-250 Controls and Indicators.....	4
Figure 2. Typical MCCB-250 Test Results Screen	9
Figure 3. Typical MCCB-250 Application	10
Figure 4. Typical Current Transformer Current Ratio Test Connections	12

CONVENTIONS USED IN THIS DOCUMENT

This document uses the following conventions:

- A key, switch, input, or knob on the MCCB-250 is indicated as **[KEY]**, **[SWITCH]**, **[INPUT]**, **[KNOB]**.
- Menu options are referenced as (*MENU OPTION*).
- MCCB-250 LCD screen output is shown as:

```
1. OPTION 1
2. OPTION 2
3. OPTION 3
4. OPTION 4
```

- Warning messages are indicated as:



Warning message

WARNING

- Important notes are indicated as:



Note details

NOTE

1.0 INTRODUCTION

1.1 General Description and Features

The MCCB-250 is a programmable, high-current source designed specifically for testing molded-case circuit breakers as well as thermal, magnetic, or solid-state overload motor-protection relays.

MCCB-250 Timer

The MCCB-250's built-in timer can test the time-delay characteristics of protection relays and molded-case circuit breakers. Once the test is initiated, the current source and the timer are automatically turned on at the next zero-crossing point of the AC. The timer stops when the MCCB-250 input detects a change in the dry contact or voltage input, or detects the removal of the test current. The test results are then displayed in milliseconds and fractions of a cycle(s) on the unit's back-lit LCD screen (20 characters by 4 lines).

MCCB-250 Current Source

The MCCB-250 has 4 current-source outputs (5 A @ 120 Vac, 25 A @ 24 Vac, 120 A @ 6 Vac, 250 A @ 3 Vac) that conduct the test current through the high-impedance load circuits. Each current source can tolerate short-duration over-loads up to 4 times the rated current. This feature is used for testing the instantaneous trip element of molded-case circuit breakers. When using this feature, the selected test current is displayed on the LCD screen. When the MCCB-250 is used as a current source, the current-flow time (the current-on period) is displayed on the LCD screen.

External Current Input

The MCCB-250 also provides an external current input (0 – 10 A). Both internal and external current source readings can be viewed at the same time.

1.2 Furnished Accessories

The MCCB-250 comes furnished with the following:

- Two 10-foot #4 AWG current cables with heavy-duty alligator clamps
- One 10-foot #10 AWG current cable
- Two 10-foot external current input cables with alligator clips
- Two 10-foot external timer input cables with alligator clips.
- One ground cable
- One power cord

1.3 MCCB-250 Technical Specifications

Table 1. MCCB-250 Technical Specifications

TYPE	250 Ampere current source
PHYSICAL SPECIFICATIONS	Dimensions: 16.8"W x 12.6"H x 10.6"D (42.6 cm x 32.0 cm x 27.0 cm); Weight: 46 lbs (21 kg)
INPUT POWER	100 – 120 Vac or 200 – 240 Vac (factory pre-set), 50/60 Hz
OUTPUT CURRENTS	0 – 5 A @ 120 Vac max; 0 – 25 A @ 24 Vac max; 0 – 120 A @ 6 Vac max; 0 – 250 A @ 3 Vac max
INTERNAL CURRENT METER	100 mA – 1000 A; Accuracy: 1% of reading \pm 20mA
MEASUREMENT METHOD	Isolated CT
EXTERNAL METER RANGE	10 mA – 10 A; Accuracy: 1% of reading, \pm 2mA
MEASUREMENT METHOD	Isolated CT
TIMER READING RANGE	1ms – 2 hours; Accuracy: 0.1% of reading \pm 1ms
TIMER STOP INPUTS	Voltage input (24V – 300V, DC or peak AC), dry contact input, or removal of primary current
DISPLAY	Back-lit LCD Screen (20 characters by 4 lines); viewable in bright sunlight and low-light levels
COMPUTER INTERFACE	RS-232C port for factory calibration and diagnostics
SAFETY	Designed to meet IEC61010 (1995), UL61010A-1, CSA-C22.2 standards
ENVIRONMENT	Operating: -10°C to 50°C (15°F to +122°F); Storage: -30°C to 70°C (-22°F to +158°F)
CABLES	Power cord, ground cable, two 10-foot (#4 AWG) test leads, one 10-foot (#10 AWG) test lead, four 10-foot external input cables
OPTIONS	Transportation case
WARRANTY	One year on parts and labor



NOTE

The above specifications are valid at nominal operating voltage and at a temperature of 25°C (77°F). Specifications may change without prior notice.

1.4 Controls and Indicators

The MCCB-250's controls and indicators are shown in Figure 1. A leader line with an index number points to each control and indicator, which is cross-referenced to a functional description in Table 2. The table describes the function of each item on the control panel. The purpose of the controls and indicators may seem obvious, but users should become familiar with them before using the MCCB-250. Accidental misuse of the controls will usually cause no serious harm. Users should also be familiar with the safety summary found on the front page of this User's Manual.

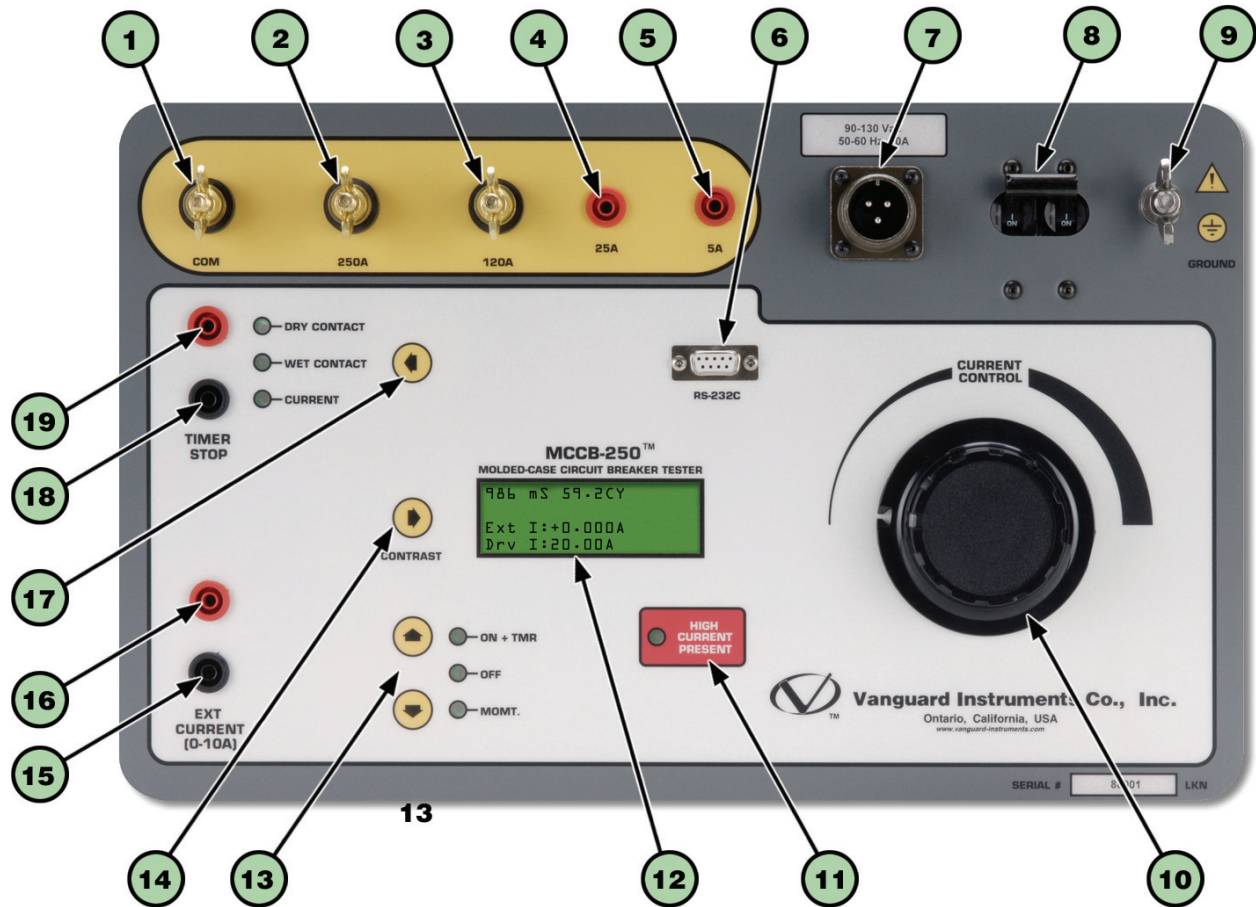

Figure 1. MCCB-250 Controls and Indicators

Table 2. Functional Descriptions of MCCB-250 Controls and Indicators

Item Number	Panel Markings	Functional Description
1	COM	Current source common terminal.
2	250A	250A current source terminal.
3	120A	120A current source terminal.
4	25A	25A current source terminal.
5	5A	5A current source terminal.
6	RS-232C	RS-232C (serial) interface port for factory firmware programming and diagnostics.
7	90-120 Vac 50-60 Hz, 20A or 200-240 Vac 50-60 Hz, 20A	Input power connector.
8	None	Circuit Breaker/Power Switch.
9	GROUND	MCCB-250 ground stud. Connect ground stud to substation ground using provided cable.
10	CURRENT CONTROL	Current control knob.
11	HIGH CURRENT PRESENT	High current presence indicator LED.
12	None	Back-lit LCD screen (20 characters by 4 lines), viewable in bright sunlight and low-light levels.
13	Up and Down Arrows	The up and down arrows are used to control the current source output and timer. Three modes are available: ON+TMR : Turn on current source and timer OFF: Turn off current source and timer MONT: Turn on current source momentarily
14	CONTRAST	LCD screen contrast control.
15 & 16	EXT CURRENT (0-10A)	External current input connectors.
17	DRY CONTACT WET CONTACT CURRENT	Timer and current source stop input selection with LED indicator.
18 & 19	TIMER STOP	Timer "STOP" input connectors.

2.0 FUNCTIONAL DESCRIPTION

2.1 MCCB-250 AC Current Source

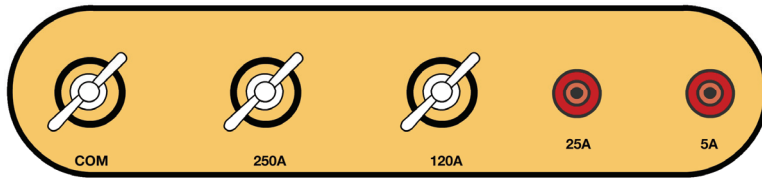

The MCCB-250 provides five AC current outputs (items 1, 2, 3, 4, and 5 in Figure 1). AC test current is set by the **[CURRENT CONTROL]** knob. This test current is measured and displayed on the LCD screen. The MCCB-250's output current ratings are shown in Table 3 and Table 4 below.

Table 3. MCCB-250 Current Output

CURRENT OUTPUT
120 Vac @ 5A
24 Vac @ 25A
6 Vac @ 120A
3 Vac @ 250A

Table 4. MCCB-250 Overload Current Output

CURRENT	ON TIME	OFF TIME
100% (1x)	30 Minutes	30 Minutes
200% (2x)	3 Minutes	5 Minutes
300% (3x)	30 Seconds	4 Minutes
400% (4x)	4 seconds	7 Minutes

2.2 MCCB-250 Current Output Control



● ON + TMR

● OFF



● MOMT.

The MCCB-250 current source output is controlled by the **[UP ARROW]** and **[DOWN ARROW]** keys (item 13 in Figure 1). Three control modes are available: ON+TMR, OFF, and MOMT.

The OFF mode indicates that both the current source output and timer are off.

The MOMT mode turns on the current source momentarily. To turn on the current source, press and hold the **[DOWN ARROW]** key. The LED indicator next to the "MOMT" label will turn on indicating that the MCCB-250 current source is on. The output current will also be displayed on the LCD screen. The MCCB-250 current output can now be set by turning the **[CURRENT CONTROL]** knob. Release the **[DOWN ARROW]** key to turn off the current source.

The ON+TMR mode turns on the MCCB-250 current source and timer. This initiates a test and is stopped by using the **[TIMER STOP]** inputs. The test results will be displayed on the LCD screen. The test can also be terminated by pressing the **[DOWN ARROW]** key.

2.3 Timer Stop Input and Control



● DRY CONTACT

● WET CONTACT



● CURRENT



After a test is started, the MCCB-250 timer can be stopped and the current source turned off using one of three modes: dry contact input, wet contact input, or interruption of the MCCB-250 current output. The **[LEFT ARROW]** key is used to select the desired mode.

TIMER STOP

When the DRY CONTACT mode is selected, the MCCB-250 will output a DC voltage to the **[TIMER STOP]**

terminals to sense the state of the dry contacts. A change in this dry contact state will stop the timer and turn off the current source.

In WET CONTACT mode, the MCCB-250 will sense an AC or DC voltage applied to the **[TIMER STOP]** terminals. The OFF state is a voltage from 0 to 10 V ac/dc. The ON state is a voltage from 24 to 300 V ac/dc. A change in the voltage state will stop the timer and turn off the current source.

In CURRENT mode, an interruption of the MCCB-250 current source output (CB contact opened) will stop the timer and turn off the current source.

Both the DRY CONTACT and WET CONTACT modes require an external input to the MCCB-250 via the **[TIMER STOP]** terminals.



The MCCB defaults to DRY CONTACT mode when it is first turned on.

NOTE

2.4 MCCB-250 Timer

The MCCB-250's built-in time/cycle counter can be used to time events in milliseconds and cycles. The elapsed time is displayed on the LCD screen along with the test current after a test is completed. A typical test results screen is shown in Figure 2. The timer is turned on when the ON+TMR mode is selected.

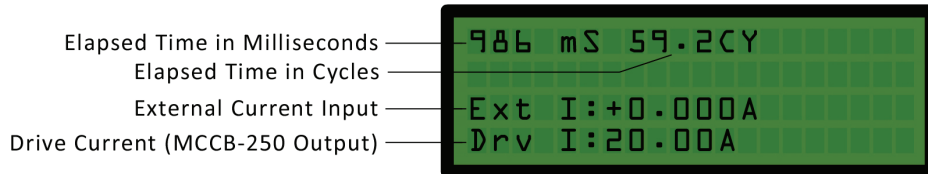

Figure 2. Typical MCCB-250 Test Results Screen

2.5 External Current Input



EXT
CURRENT
(0-10A)

The MCCB-250's **[EXT CURRENT]** input serves as a built-in ampere meter that can be used to monitor an AC current. This current is isolated, and the maximum input current is 10 amperes. A typical application for this feature is to measure a current transformer (CT) current ratio. The MCCB-250 can be used to output a current to the CT primary input. The CT secondary output is then connected to the MCCB-250's **[EXT CURRENT]** input. Both the MCCB-250 output current and the CT secondary current are displayed on the LCD screen (see Figure 2). The user can use the displayed values to quickly calculate the CT current ratio manually.

2.6 LCD Contrast Control



CONTRAST

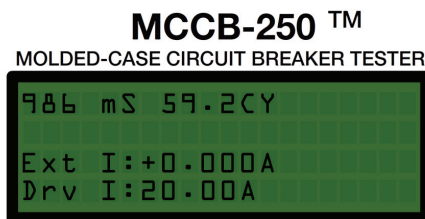

To change the LCD screen's contrast, press and hold the **[RIGHT ARROW]** key next to the LCD screen (item 14 in Figure 1). The screen contrast will increase until it reaches the darkest setting. Then it will return to the lightest setting and begin increasing the contrast again. Release the **[RIGHT ARROW]** key when the desired contrast level has been reached.



NOTE

The MCCB-250 will store the current LCD setting in non-volatile memory.

3.0 OPERATING PROCEDURES

3.1 Testing the Time Delay of a Protection Relay

Figure 3 illustrates a typical connection of the MCCB-250 to a protection relay to test its “Open Time Delay”. The MCCB-250 injects a test current through a bus. The test current is sensed by the CT of the protection relay. One of the relay dry contacts is used to stop the MCCB-250 timer.

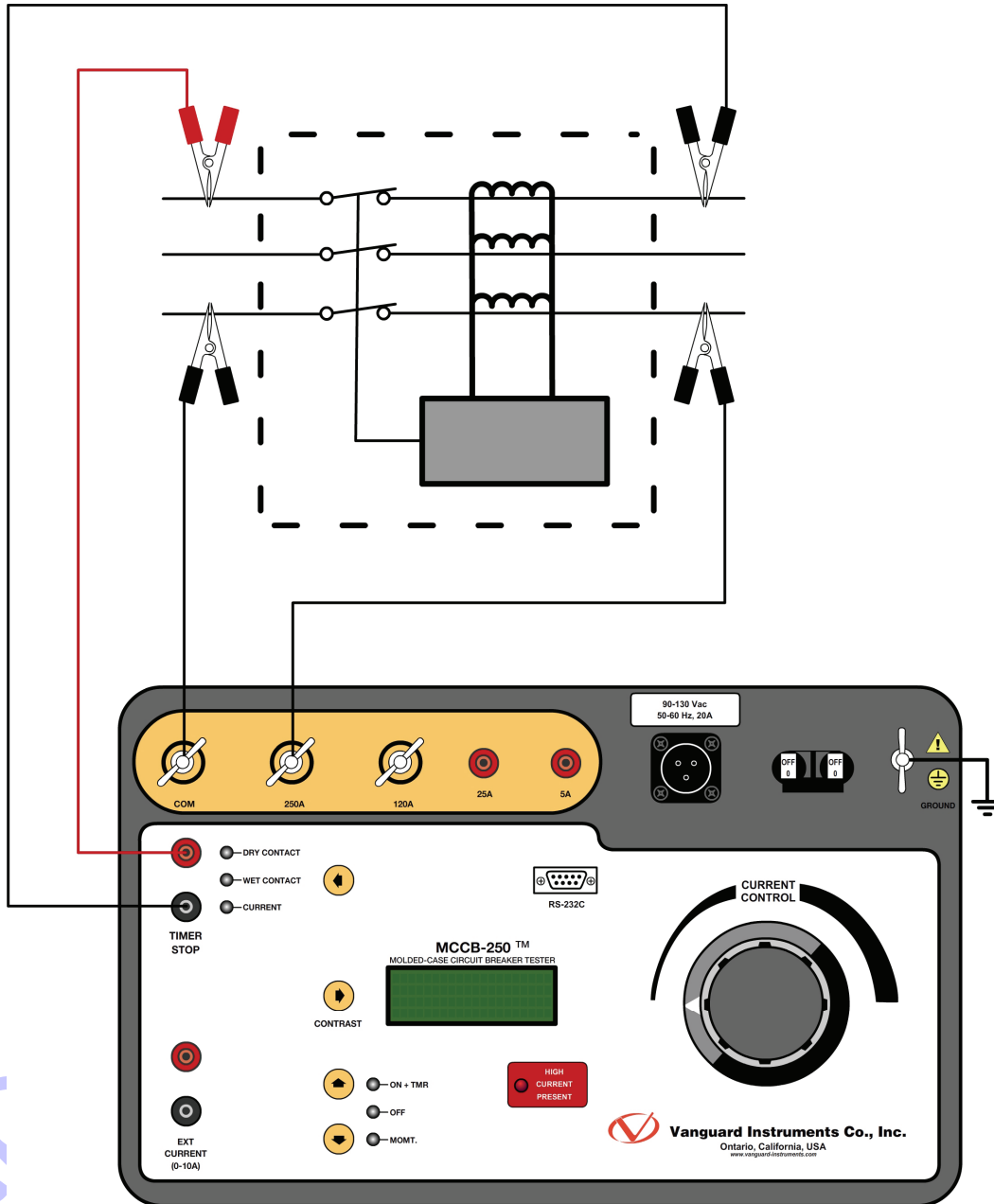

Figure 3. Typical MCCB-250 Application

Use the steps below to test the time delay of a protection relay:

- a. Connect the Safety Ground to the MCCB-250.
- b. Connect the AC power cord.
- c. Connect the Current Cables from the MCCB-250 to the bus as shown in Figure 3.
- d. Connect the **[TIMER STOP]** cables as shown in Figure 3.
- e. Turn the **[CURRENT CONTROL]** knob to zero.
- f. Turn on the **[POWER SWITCH]**.
- g. Select the DRY CONTACT mode for the **[TIMER STOP]** input by pressing the **[LEFT ARROW]** key until the DRY CONTACT LED light is illuminated.
- h. Hold the **[DOWN ARROW]** key to momentarily turn on the current source. Note that the HIGH CURRENT PRESENT LED will be illuminated.
- i. Turn the **[CURRENT CONTROL]** knob to set the desired current.
- j. Release the **[DOWN ARROW]** key.
- k. Press the **[UP ARROW]** key to select the ON+TIMER mode and start the test. The MCCB-250 will inject the preset current into the bus and turn on the timer. The timer will stop and the current source will be turned off when the MCCB-250 **[TIMER STOP]** input detects a change in the relay dry contact. A typical MCCB-250 time delay test results screen is shown below:

```
986 mS 59.2CY  
Ext I:+0.000 A  
Drv I:20.00A
```

**NOTE**

In the above test, the timer will be stopped and the current source turned off by a change of state in the **[TIMER STOP]** input or when the operator presses the **[DOWN ARROW]** key to select the OFF mode. If the test is aborted by the operator, no timer or current information is displayed.

3.2 Measuring Current Transformer Primary and Secondary Currents

Figure 4 shows a typical connection of the MCCB-250 to a current transformer. In this configuration, the MCCB-250 injects a test current through the CT primary. The CT secondary current is sensed by the MCCB-250's **[EXT CURRENT]** input.

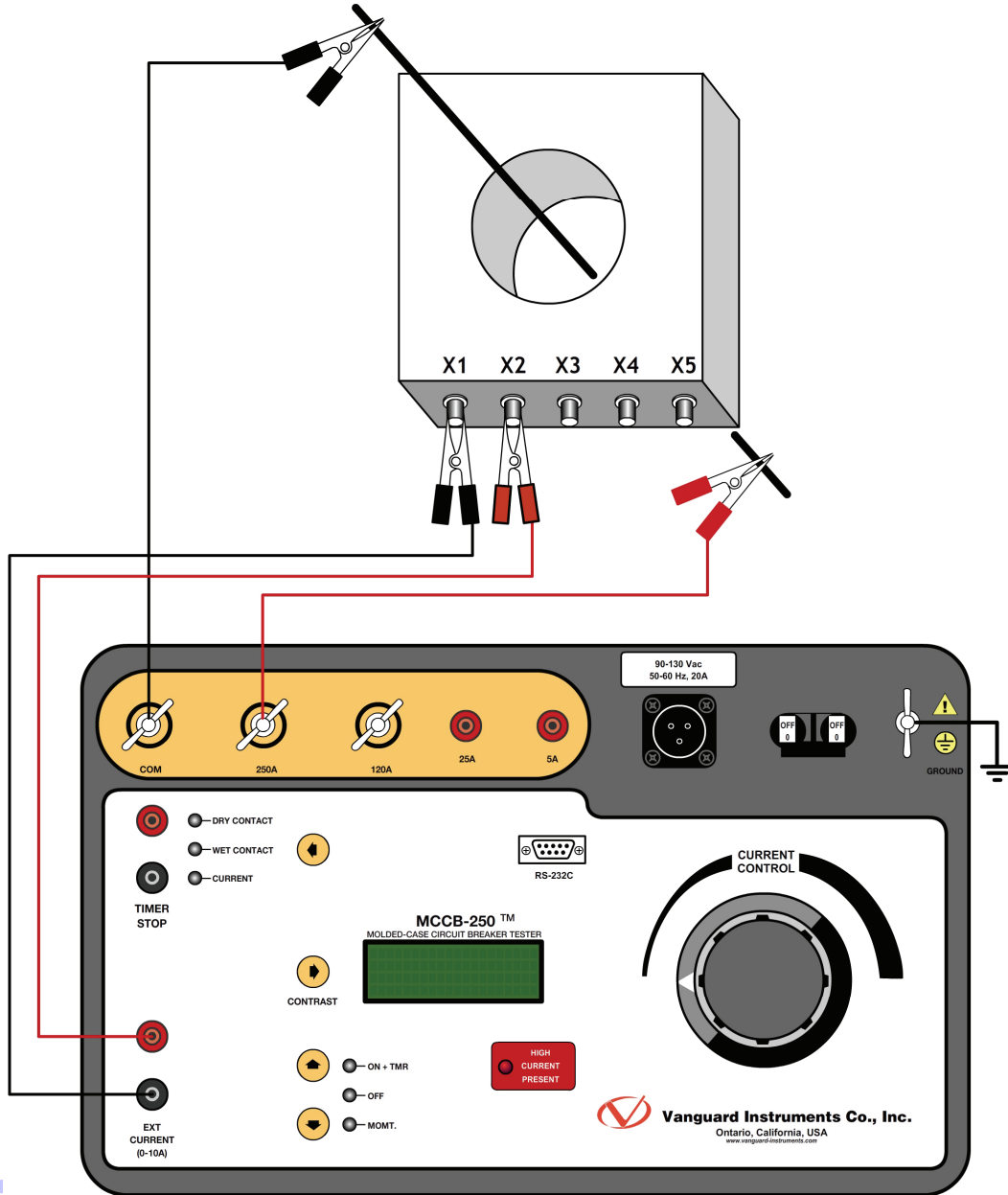
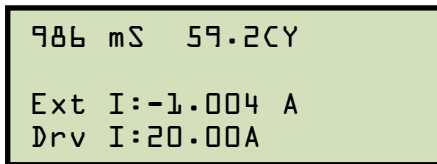

Figure 4. Typical Current Transformer Current Ratio Test Connections

Follow the steps below to measure the CT primary and secondary currents:

- a. Connect the Safety Ground to the MCCB-250.
- b. Connect the Current cables from the MCCB-250 to the bus (CT primary) as shown in Figure 4.
- c. Connect the CT secondary winding to the MCCB-250 **[EXT CURRENT]** input as shown in Figure 4.
- d. Turn the **[CURRENT CONTROL]** knob to zero.
- e. Turn on the **[POWER SWITCH]**.
- f. Hold the **[DOWN ARROW]** key to momentarily turn on the current source.
- g. Turn the **[CURRENT CONTROL]** knob to set the desired current.
- h. Release the **[DOWN ARROW]** key.
- i. Press the **[UP ARROW]** key to select the ON+TIMER mode and to start the test.
- j. Observe and record the CT primary and secondary current and the polarity displayed on the LCD screen. A typical LCD screen display is shown below:



```
986 mS 59.2CY
Ext I: -1.004 A
Drv I: 20.00A
```

**NOTE**

The external current polarity is shown as in phase (“+” sign) or out of phase (“-”) with respect to the MCCB-250 drive current. The CT turns ratio can be obtained by taking the current ratio.

- k. Turn off the current source by pressing the **[DOWN ARROW]** key.



**Vanguard Instruments
Company, Inc.**

1520 S. Hellman Ave • Ontario, CA 91761 • USA

Phone: 909-923-9390 • Fax: 909-923-9391

www.vanguard-instruments.com



Copyright © 2009 by Vanguard Instruments Company, Inc.

MCCB-250 User's Manual • Revision 2 • September 15, 2009 • TA